

Masport®

OUTDOOR OVEN

Woodfired Pizza Oven

Part Number **553237**

<u>External</u>	Width (Tables Open)	1720mm
<u>Dimensions</u>	Width (Tables Closed)	1050mm
	Depth	890mm
	Height (Top of Tables)	985mm
	Height (Top of Oven)	1600mm
	Height (Top of Chimney)	2555mm

Month and Year of Manufacture: Sept 2021



Issue A.0
June 2021 PB
ECN # 12849
IPL Ref # 753237



553237 Woodfire Pizza & Outdoor Oven

Masport®

Issue A.0
June 2021 PB
ECN # 12849
IPL Ref # 753237

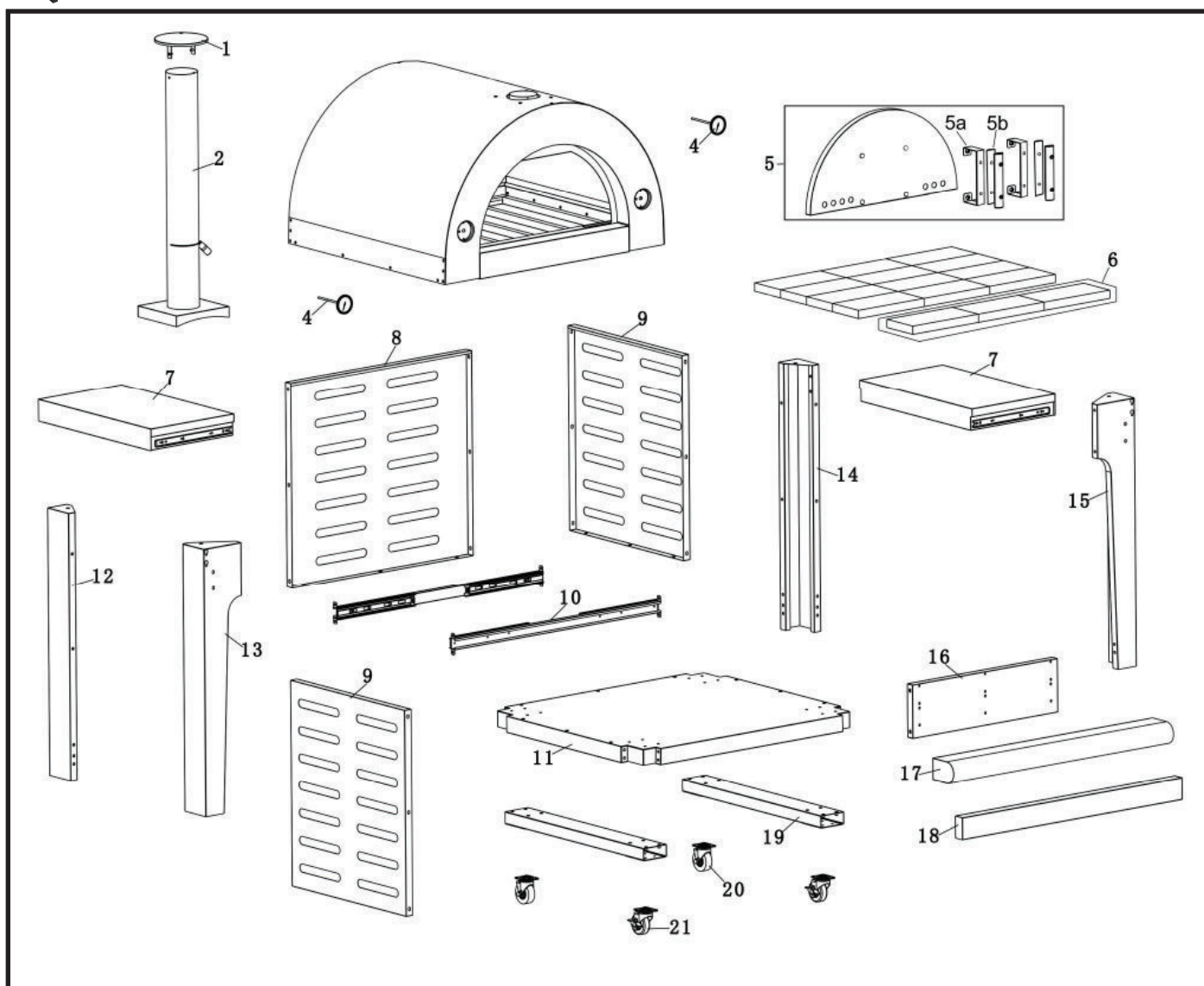

Item	Part No	Description	Qty	Item	Part No	Description	Qty
1	546459	Chimney, Cap	1	19	546474	Brace- Wheel Support	2
2	546458	Chimney	SS 1	20	8A01102002	Castor- Plate Mount, No Locking	2
4	8A32301008	Gauge- Temperature	2	21	8A01102001	Castor- Plate Mount, Locking	2
5	546457	Door- Oven, Assembly	1	Not Illustrated			
5a	546447	*Bracket, Door Handle	2	546451	Cover- Fabric, W/Fire Pizza Oven	1	
5b	546446	*Handle- Wood, (Dark)	4	546710	Owner Manual	1	
6	546904	Brick- Pizza, (3 Bricks per Pack)	5	546774	Bolt-Pack, Wheel Assembly	1	
7	546462	Table- Side, Retractable	2	546775	Bolt-Pack, Cabinet Assembly	1	
8	546466	Panel- Rear, Cabinet	1	Optional Extras			
9	546464	Panel- Side, LH/RH Cabinet	2	546450	Peel- Pizza, (Long Handle)	1	
10	546467	Slider- Fixed	2				
11	546475	Panel- Bottom, Cabinet	1				
12	546465	Leg- Left Rear	1				
13	546469	Leg- Left Front	1				
14	546468	Leg- Right Rear	1				
15	546470	Leg- Right Front	1				
16	546471	Panel- Front	1				
17	546463	Dashboard- Upper	1				
18	546473	Dashboard- Lower	1				

When ordering spares: PLEASE QUOTE PART NUMBER & DESCRIPTION, NOT illustrated number. Item Qty = 1 per part unless stated differently.
BOLD TEXT = Assemblies. Descriptions starting with * = items included in the assemblies & may not be available as a spares item.
Determine the left or right hand sides by standing in the operating position (standing at the handle).